



Austin Dressage Unlimited's 6th Annual Judging Seminar
“Improving Your Judging Eye & Showing Skills”

featuring FEI 5 International & Olympic Judge Wim Ernes*

January 10-11, 2015

Southwestern University, Georgetown, Tx

Wim Ernes is a 5* FEI Olympic level dressage judge popular around the world. He was previously the Dutch Dressage Team's Head coach for the 1996 Olympics in Atlanta where Holland won Team Silver and Anky won the individual Gold medal. After that he concentrated on his career as an International FEI Judge. He received his “O” Judges stature in 2007 and was a member of the prestigious Judging Team at the 2012 Olympic Games in London. Wim is also an expert on breeding, and is the President of the Stallion Selection Committee for the KWPN. The Netherlands Federation announced that Wim Ernes has been signed on as Head Coach of the Dutch Dressage Team again now through the 2016 Olympics in Rio de Janeiro. Wim is a regular headline speaker at the Global Dressage Forum each year. This seminar with Wim Ernes promises to give us top-of-the-World-class advice from the perspective of a Judge, a Trainer, an Instructor, and a Breeder. You won't want to miss it!



Special Amenities:

- **For Full Participant Judges, L Grads & L Candidates: Special seating, & Lunch on Saturday with Wim Ernes.**
- **For Instructors/Trainers: Special seating just behind the Judges/L's, & Lunch on Sunday with Wim Ernes.**
- **For Juniors/Young Riders: Special front row seating, & Dinner on Friday evening with Wim Ernes, after lecture room set up.**

Additional Handouts, freebies, & door prizes for participants!

REGISTRATION: FIRST 30 REGISTRANTS GET A FREE GIFT!!

Mail-In Registration Form*: [CLICK HERE](#)

*Registration form must be completely filled out and accompanied by a check.

Online Registration: [CLICK HERE](#)

DIRECTIONS: [Southwestern University](http://www.southwestern.edu); 1001 E. University Ave, Georgetown, TX 78626
 F.W. Olin Hall, Bldg #11, lecture Room #105
 Printable Directions <http://www.southwestern.edu/visit/gettinghere.php>

Southwestern University *Campus Map*

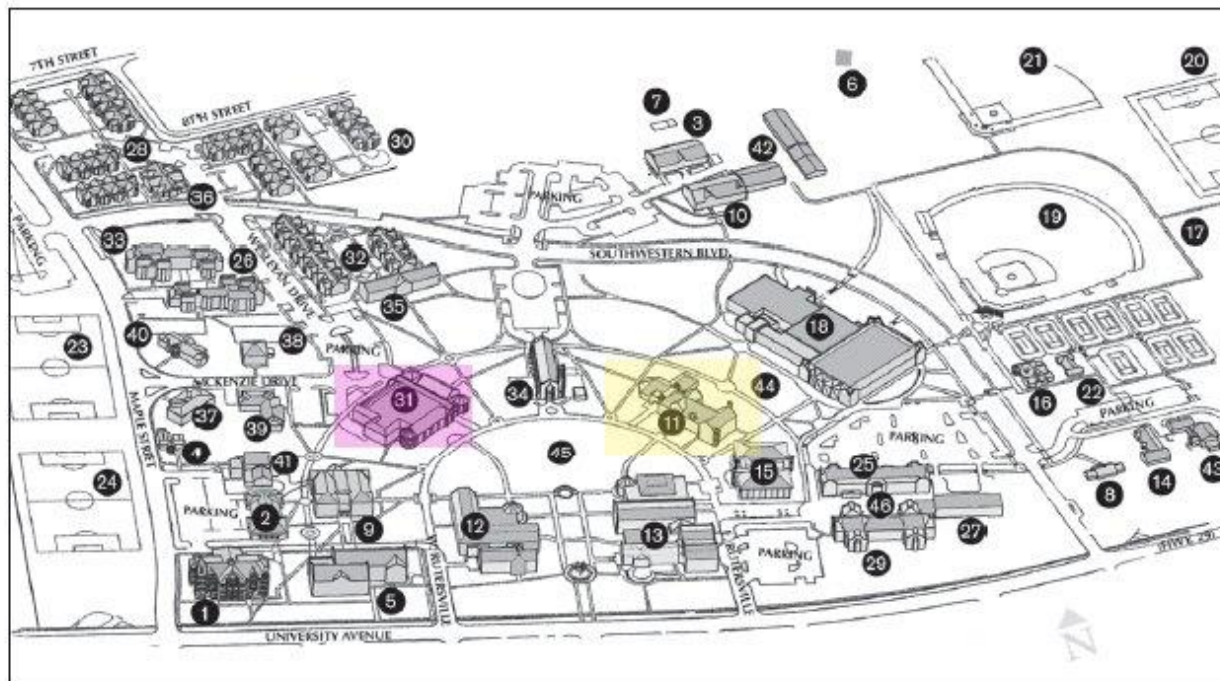

Academics and Administration

1. Roy and Lillie Cullen Building
2. The Wilhelmina Cullen Admission Center
3. Rufus Franklin Edwards Studio Arts Building
4. Field House (Campus Police)
5. Fondren-Jones Science Hall
6. Fountainwood Observatory
7. Greenhouse and Community Garden
8. McCook-Crain Building
9. Mood-Bridwell Hall
10. Joe S. Mundy Hall
11. F.W. Olin Building
12. A. Frank Smith, Jr. Library Center
13. Alma Thomas Fine Arts Center
14. Kyle E. White Building
15. The Charles and Elizabeth Prothro Center for Lifelong Learning

Athletics and Recreation

16. Julie Puett Howry Center
17. Kurth-Landrum Golf Course
18. Corbin J. Robertson Center
19. Rockwell Baseball Field
20. Soccer Fields
21. Taylor-Sanders Softball Field
22. Marvin D. Henderson, Sr. Tennis Courts
23. Robert K. Moses, Jr. Field
24. Snyder Athletic Field

Residence and Student Life

25. Brown-Cody Residence Hall
26. Herman Brown Residence Hall
27. Ernest L. Kurth Residence Hall
28. Grogan & Betty Lord Residence Hall
29. J.E. & L.E. Mabee Residence Hall
30. Dorothy Manning Lord Residential Center (includes Community Room)

31. Red & Charline McCombs Campus Center **Lunch**

32. Charline Hamblin McCombs Residential Hall
33. Moody-Shearn Residence Hall
34. Lois Perkins Chapel
35. Martin Ruter Residence Hall
36. Sharon Lord Caskey Community Center (including Sorority Chapter Rooms)

Fraternities

37. Kappa Alpha House
38. Kappa Sigma House
39. Phi Delta Theta House
40. Pi Kappa Alpha House

Physical Plant

41. Central Chiller Station
42. Physical Plant Building & Warehouse

Other

43. Turner-Fleming House
44. J. N. R. Score Quadrangle
45. Roy H. Cullen Academic Mall
46. Laura Kuykendall Garden

PARKING:

Campus police say you may park along any road on campus, or in the large parking lot that is directly north of the Chapel across Southwestern Blvd. Please avoid parking in any of the Residence Hall parking lots, as these are for students living on campus.

DAILY SCHEDULE:

Saturday: 9–12:30 seminar 12:30–2 extended lunch break 2–5pm seminar

Sunday: 8–11:30 seminar 11:30–12:30 lunch break 12:30–4 seminar

LUNCH:

*Note, there will be an extended lunch break on Saturday, and a shorter one on Sunday. Attendees are free to take lunch wherever they see fit – on campus, downtown or elsewhere around Georgetown.

“The Commons.” is a buffet style cafe available on the Southwestern University campus in the Red & Charline McCombs Campus Center (#31 on the campus map). Open 10:30-2pm. One fee includes all you can eat, including drinks and desserts in this cafe.

Saturday lunch buffet is \$7.25/person Sunday Brunch is \$9/person.

EVENT HOTEL: DISCOUNT RATE OFFERED UNTIL 12/9

Candlewood Suites - discounted room rates of **\$75 (single), \$80 (double)** per night ***if booked by Dec 9th*** for Seminar attendees. 512-591-7888 <http://www.candlewoodsuites.com>

Call them directly and mention group code “**Austin Dressage Unlimited**” to receive the discount.

Visit the ADU website for more information

<http://austindressageunlimited.org/wimermes.pdf>

To speak to a live body, contact Carol Schmickrath 512-863-5005, Brookstonefarm@aol.com